



Rimbun — *Aman* —

Seremban 2 Heights

*The perfect home
that's cozy & comfortable*

The Beauty Of A 1-Storey Link Home

When single-storey homes are still very much sought-after, this is the perfect opportunity for you to discover Rimbun Aman homes - the latest phase in the matured township of Seremban 2. Rimbun Aman is the perfect choice for modern families seeking a home in a conducive environment.

Well-Designed Homes & Community Open Spaces

Picture this - a close-knit community among a neighbourhood with well-organised landscaping and open spaces for the community to mingle and interact. Rimbun Aman homes come as one complete package with three types comfortable 1-storey link homes to choose from.

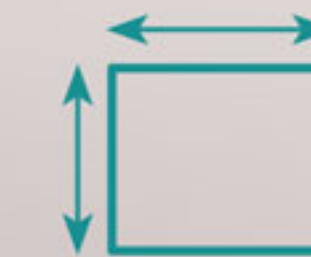

20' x 60' / 20' x 65'
/ 22' x 65'



Built-up
971 - 1,135 sq. ft.



3 bedrooms &
2 bathrooms





Artist's impression

Comfortable & Cozy

The practical layouts of Rim bun Aman mean space is maximised, yet giving a sense of coziness that everyone looks for in any home.



Artist's impression



Artist's impression

Site Plan



LEGEND

Phase 1

20' x 60'

Phase 2

20' x 65'

22' x 65'

B Bumi Lot



Floor Plan (Phase 1)

Lot Size: 20' x 60' | Built-up: 971 - 1,035 sq. ft.



Floor Plan (Phase 2)

Lot Size: 20' x 65' | Built-up: 971 - 1,035 sq. ft.



Floor Plan (Phase 2)

Lot Size: 22' x 65' | Built-up: 1,071 - 1,135 sq. ft.



Specifications

STRUCTURE	: Reinforced concrete frame / wall
WALLS	: Brick wall / reinforced concrete wall
ROOF	: Concrete roof tiles / reinforced concrete roof
CEILING FINISHES	: Skimcoat / ceiling board
FLOOR FINISHES	
Living, dining, bedrooms, bathrooms & kitchen	: Ceramic tiles
Car porch, driveway & terrace (corner/end odd)	: Concrete imprint
Apron & yard	: Cement render
WALL FINISHES	
Kitchen	: Ceramic wall tiles up to 1.5m height at sink's wall only
Bathrooms	: Ceramic wall tiles up to 1.5m height
Internal walls to other areas	: Cement plaster & emulsion paint
External walls	: Cement plaster & weather resistant paint
DOORS	
Door to living & terrace (corner)	: Aluminium frame with clear glass
Door to bedrooms & kitchen	: Flush doors
Door to bathrooms	: Folding doors
WINDOWS	: Aluminium frame with clear / obscure glass
SANITARY FITTINGS	
Kitchen	: Single bowl single drainer aluminium sink
Bathrooms	: Wall hung basin, shower head & pedestal water closet
ELECTRICAL INSTALLATIONS WITH SINGLE PHASE WIRING	
WITH SEMI-UNDERGROUND	: Intermediate / End Corner
Lighting point	: 12 13
Power point	: 11 11
Fan point	: 5 5
Air-cond point	: 2 2
Water heater point	: 2 2
Telephone outlet	: 1 1
TV point	: 1 1
EXTERNAL	
Fence for intermediate	: Brick wall fence at front & front between 2 units
Fence for corner & end	: Brick wall fence at front, side & front between 2 units
	: Chain link fence at back & back between 2 units
	: Mild steel gate

Township With A Vibrant, Happy Community

Rimbun Aman's location in the vibrant Seremban 2 means residents here can have the pleasure of enjoying an award-winning, well-planned township. One that comes with matured facilities and amenities. Everything needed for a modern lifestyle of convenience is just a short distance away. Life couldn't be any better.



Government Precinct
 15-Arce City Park
 Masjid Hussain
 Schools
 Mydin Mall
 Uptown Avenue
 SEHAT Healthcare Centre
 Banks
 AEON
 IJM Land Sales Office
 S2 Club
 Kepayang Hill

All within Seremban 2:

- Primary & secondary schools
- 30-acre Adventure Hill Park
- Popular 15-acre City Park
- S2 Club
- AEON Mall, Mydin Mall, TESCO & NSK
- Medical & healthcare centres
- Sports complex
- Government Administrative Centre

Excellent accessibility:

- Direct access to North-South Highway via Seremban toll plaza
- Access via Jalan Labu
- Seremban-Bukit Nenas Expressway
- Toll-free connection to KLIA / KLIA 2

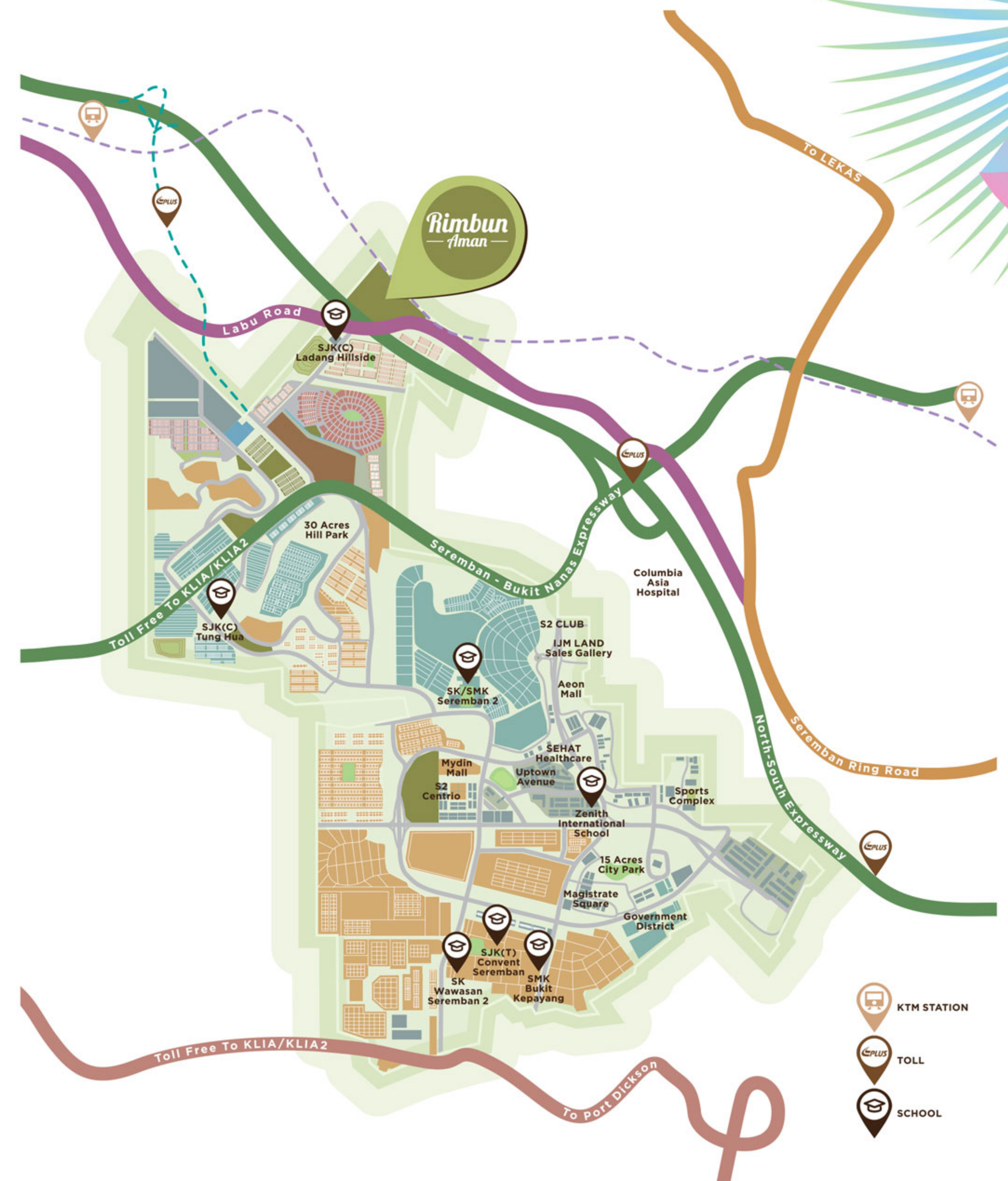

CALL US

1800 222 456
seremban2.ijmland.com

SALES GALLERY WORKING HOURS

Monday - Saturday | 9 am - 5 pm
Sunday & Public Holiday | 10 am - 5 pm

SALES GALLERY ADDRESS

Seremban Two Holdings Sdn. Bhd. 199501028262 (357468-H)
PT 10786 Seremban 2, 70300 Seremban, Negeri Sembilan.

IJM LAND

An  Company

RIMBUN AMAN • Type Of Property: 1-Storey Terrace House (Phase 1) • Developer: Seremban Two Holdings Sdn. Bhd. 199501028262 (357468-H) • Address: PT 10786, Seremban 2, 70300 Seremban, Negeri Sembilan • Developer's Licence No: 9567-25/09-2023/0681(L) • Validity: 21/09/2021 - 20/09/2023 • Advertising & Sales Permit No: 9567-25/09-2023/0681(P) • Validity: 21/09/2021 - 20/09/2023 • Land Tenure: Freehold • Land Encumbrances: Nil • Expected Date Of Completion: April 2023 • Price: (Phase 1) RM462,136 (Min.) – RM657,336 (Max.) • Total Phase 1 Units: 20' x 60' - 120 Units • Building Plan Reference No: MBS.S.KB1 - 09/2020 • Approving Authority: Majlis Bandaraya Seremban

• Type Of Property: 1-Storey Terrace House (Phase 2) • Developer's Licence No: 9567-24/05-2023/0479(L) • Validity: 26/05/2021 – 25/05/2023 • Advertising & Sales Permit No: 9567-24/05-2023/0479(P) • Validity: 26/05/2021 – 25/05/2023 • Land Tenure: Freehold • Expected Date Of Completion: April 2023 • Price: (Phase 2) 20' x 65' RM474,336 (Min.) – RM734,196 (Max.) • 22' x 65' RM512,156 (Min.) – RM620,736 (Max.) • Total Phase 2 Units: 20' x 65' - 174 Units, 22' x 65' - 10 Units • Building Plan Reference No: MBS.S.KB1 - 09/2020 • Approving Authority: Majlis Bandaraya Seremban

THIS ADVERTISEMENT HAS BEEN APPROVED BY THE NATIONAL HOUSING DEPARTMENT

The information contained herein is subject to change without notification as may be required by the relevant authorities or developer's project consultant. Whilst every care has been taken in providing the information, the developer cannot be held responsible for any variations. For avoidance of doubt on the specifications, please refer to the Sale and Purchase Agreement. All illustrations are artist's impressions only.